

# Soils Map

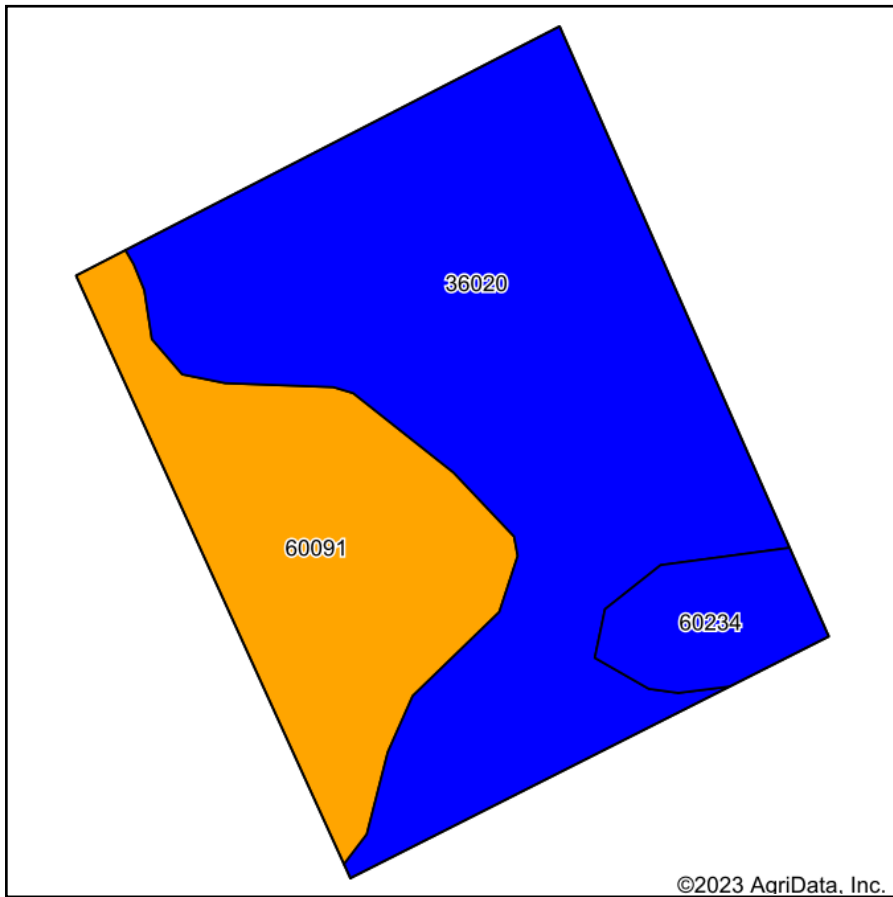

Soils data provided by USDA and NRCS.

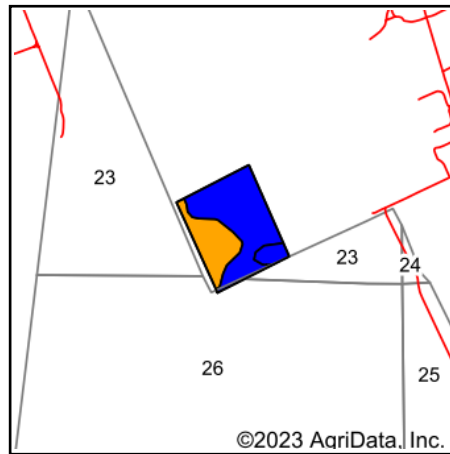

State: **Missouri**  
 County: **St. Charles**  
 Location: **38° 54' 4.52, -90° 45' 23.23**  
 Township: **O'Fallon**  
 Acres: **34.04**  
 Date: **9/20/2023**

MEYER & COMPANY  
 REAL ESTATE AUCTIONS  
 BOUNDARY LINES  
 ARE APPROXIMATE

Maps Provided By:



Area Symbol: MO183, Soil Area Version: 23

| Code                    | Soil Description   | Acres | Percent of field | Non-Irr Class Legend | Non-Irr Class *c | Alfalfa hay Tons | Caucasian bluestem Tons | Common bermudagrass Tons | Orchardgrass red clover Tons | Tall fescue Tons | Warm season grasses Tons | *n NCCPI Soybeans |
|-------------------------|--|-------|------------------|----------------------|------------------|------------------|-------------------------|--------------------------|------------------------------|------------------|--------------------------|-------------------|
| 36020                   | Kennebec silt loam, 0 to 2 percent slopes, occasionally flooded    | 22.17 | 65.1%            |                      | Ilw              | 5                | 8                       | 7                        | 7                            | 7                | 9                        | 72                |
| 60091                   | Edinburg silty clay loam, 0 to 1 percent slopes, frequently ponded | 9.62  | 28.3%            |                      | Illw             |                  | 2                       | 8                        | 7                            | 8                | 10                       | 44                |
| 60234                   | Weller silt loam, 2 to 5 percent slopes                            | 2.25  | 6.6%             |                      | Ile              |                  |                         |                          |                              |                  |                          | 61                |
| <b>Weighted Average</b> |  |       |                  |                      | <b>2.28</b>      | <b>3.3</b>       | <b>5.8</b>              | <b>6.8</b>               | <b>6.5</b>                   | <b>6.8</b>       | <b>8.7</b>               | <b>*n 63.4</b>    |

\*n: The aggregation method is "Weighted Average using all components"

\*c: Using Capabilities Class Dominant Condition Aggregation Method

Soils data provided by USDA and NRCS.